

SCHEMATIC DIAGRAM

CAPACITOR	REMARKS	PARTS NAME
NO MARK		ELECTROLYTIC CAPACITOR
⊗		TANTALUM CAPACITOR
⊙		CERAMIC CAPACITOR
⊕		POLYESTER FILM CAPACITOR
○		POLYSTYRENE FILM CAPACITOR
◇		MICA CAPACITOR
⊖		POLYPROPYLENE FILM CAPACITOR
⊙		SEMICONDUCTIVE CERAMIC CAPACITOR

RESISTOR	REMARKS	PARTS NAME
NO MARK		CARBON FILM RESISTOR (1/4W)
⊗		METAL OXIDE FILM RESISTOR
⊕		METAL FILM RESISTOR
⊖		METAL PLATE RESISTOR
⊙		FIRE PROOF CARBON FILM RESISTOR
◇		CEMENT MOLDED FILM RESISTOR
⊖		SEMI VARIABLE RESISTOR
⊙		CHIP RESISTOR

NOTICE  
 (J)..... Japanese model  
 (U)..... U.S.A. model  
 (C)..... Canadian model  
 (A)..... Australian model  
 (G)..... European model  
 (B)..... British model  
 (R)..... General model  
 (P)..... PP model

	U.C.R.A.B	B	LAST NO.	LN LISTED NO.
#1	C73.74.79.80	OPEN	⊕ 0.01/100	
#2	C75.78	OPEN	0.022	C 90
#3	R159-162	OPEN	2.2	
#4	C75.77	OPEN	0.047	R 173
#5	C72	OPEN	0.1/250	
#6				
#7	C87-88	OPEN	100P	Q 60
#8	CC83-86	OPEN	⊕ 470P/100	O 37
#9	C89-90	OPEN	⊕ 0.1	
				IC 6

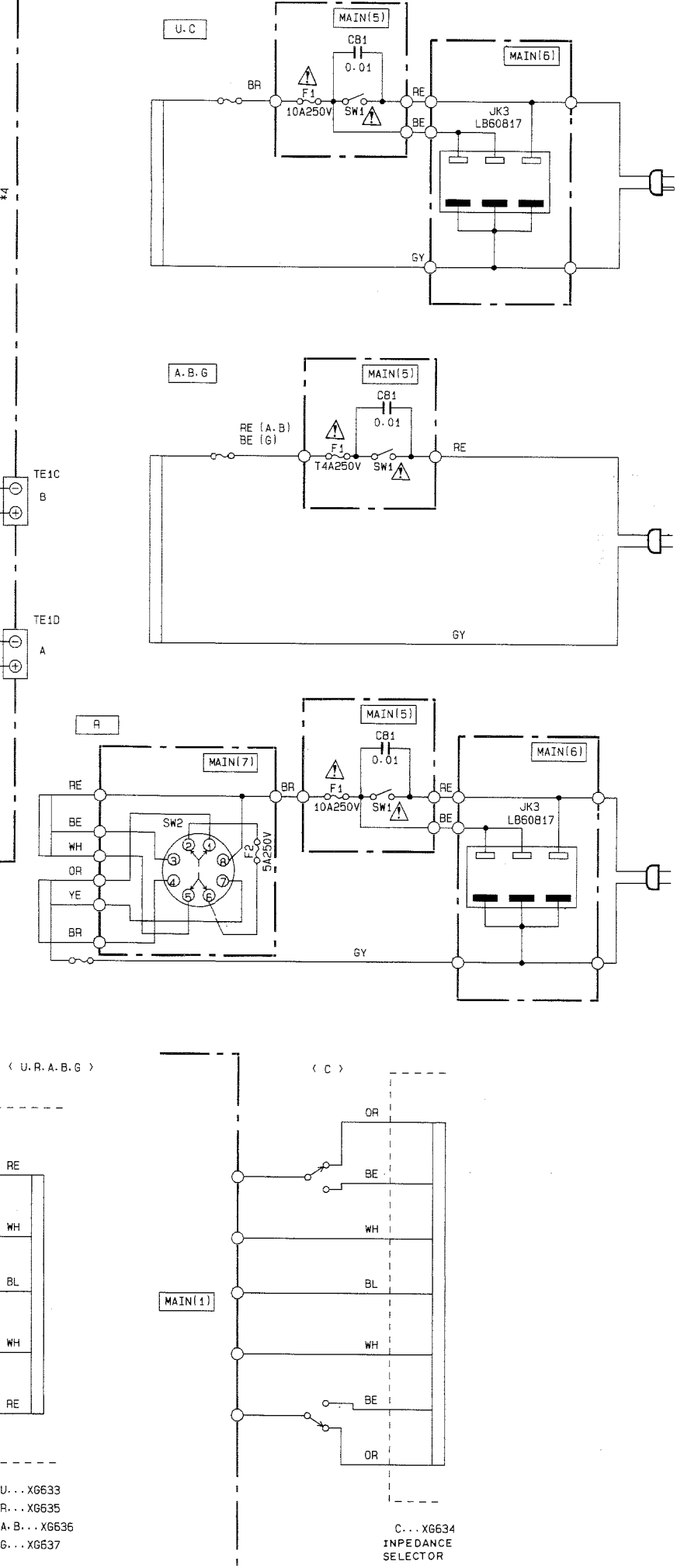
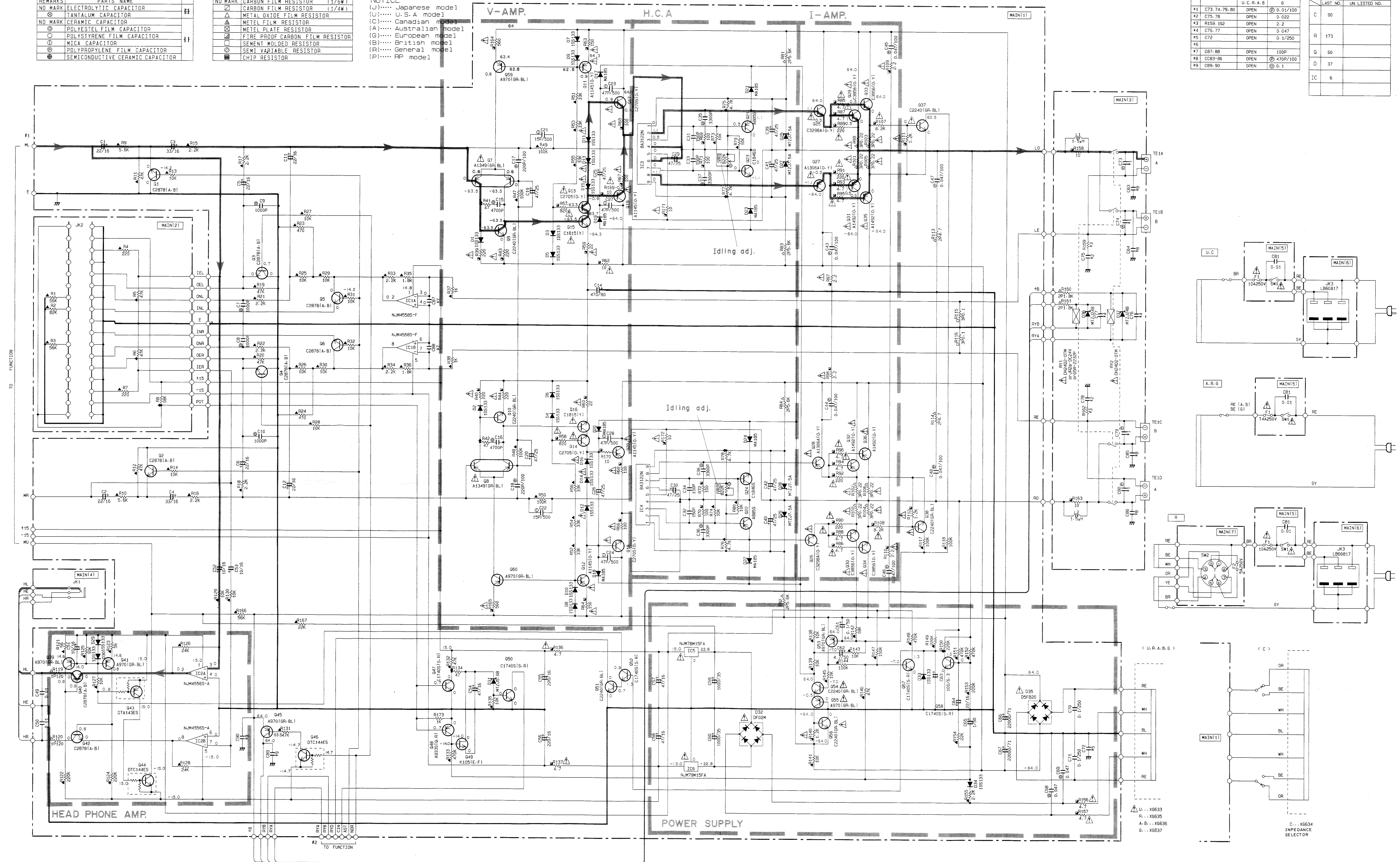

A933S(Q,R)	⊕ A111S(E,F)	⊕ A131Q(R,S,T)
C1740S(S,R)	⊕ C2603(E,F)	⊕ C2312(R,S,T)
K105(E,F)	⊕ K105(F,H)	
C184S	⊕ D1681(S,T)	
AB85	⊕ B1141(S,T)	

YST Cartridge	Speaker ON Position		A + B	
	A	B	A - Speaker Terminal	B - Speaker Terminal
Cartridge ON	YST Power Amp.	Normal Amp.	YST Power Amp.	-
Cartridge OFF	Normal Amp.	Normal Amp.	Normal Amp.	Normal Amp.

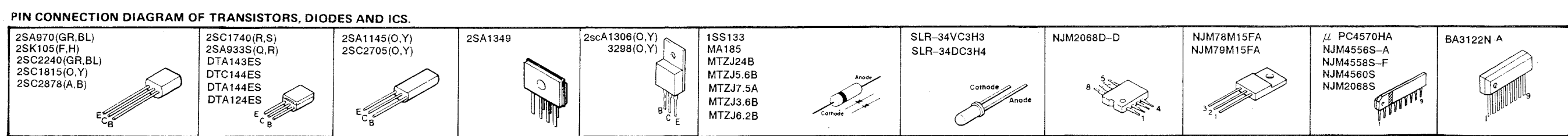

• The voltages are measured with no-signal mode.  
 • All voltages are measured with a 10MΩ/V DC electric volt meter.  
 • Components having special characteristics are marked ⊕ and must be replaced with parts having specifications equal to those originally installed.  
 • Schematic diagram is subject to change without notice.

SCHEMATIC DIAGRAM

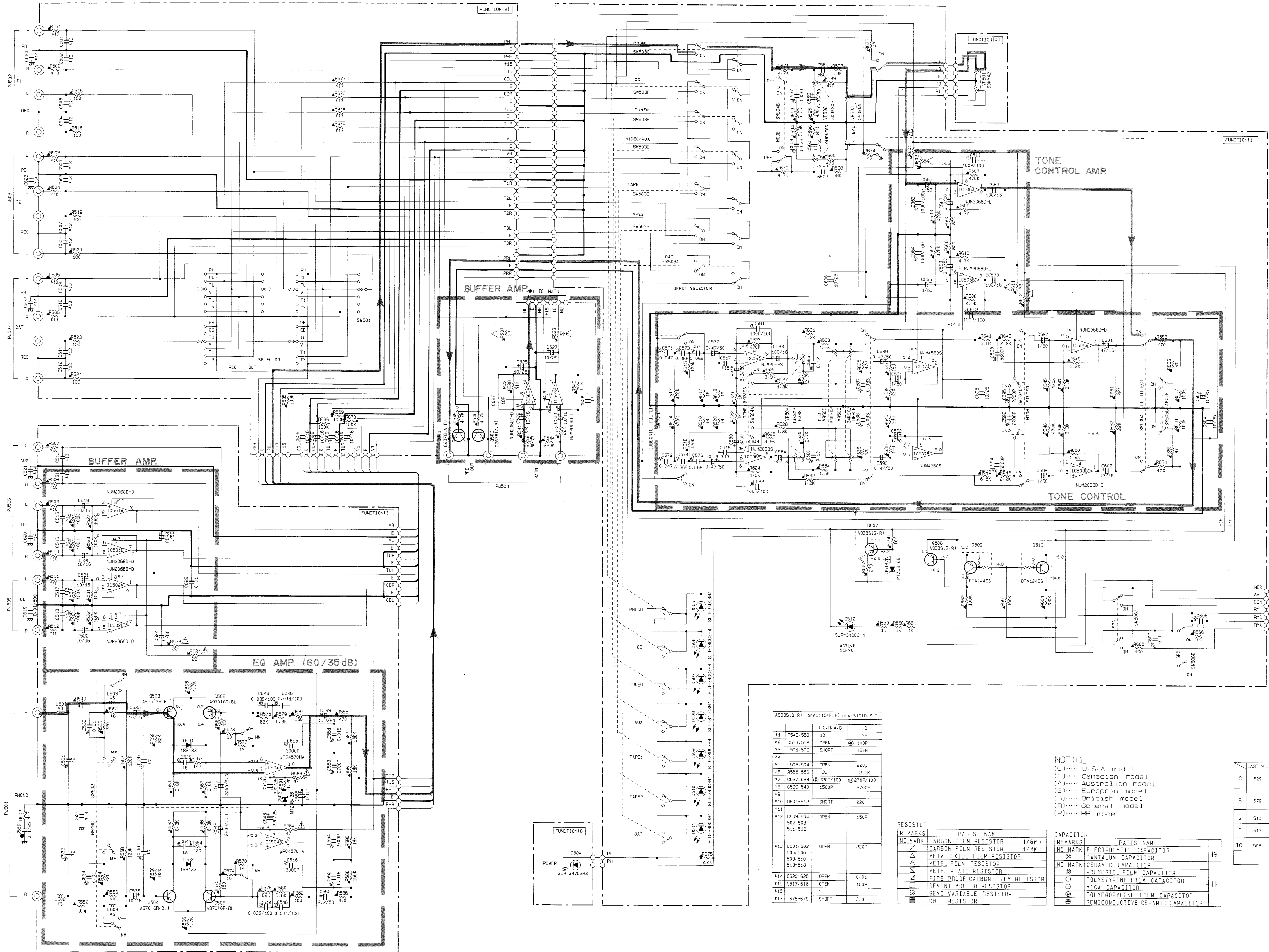

U.C.R. A.B	Q
*1 R549-550	33
*2 C531-532	OPEN 100P
*3 L501-502	SHORT 15μH
*4	
*5 L503-504	OPEN 220μH
*6 R555-556	33 2.2K
*7 C537-538	220P/100 270P/100
*8 C539-540	1500P 2700P
*9	
*10 R501-512	SHORT 220
*11	
*12 C503-504	OPEN 150P
507-508	
511-512	
*13 C501-502	OPEN 220P
505-506	
509-510	
513-518	
*14 C520-625	OPEN 0.01
*15 C617-618	OPEN 100P
*16	
*17 R676-679	SHORT 330

REMARKS	PARTS NAME	1/6W	1/4W
NO MARK	CARBON FILM RESISTOR		
△	METAL OXIDE FILM RESISTOR		
□	METAL FILM RESISTOR		
▢	METAL PLATE RESISTOR		
⊠	FIRE PROOF CARBON FILM RESISTOR		
⊞	SEMENT MOLDED RESISTOR		
⊚	SEMI VARIABLE RESISTOR		
■	CHIP RESISTOR		

**NOTICE**  
 (U)..... U.S.A model  
 (C)..... Canadian model  
 (A)..... Australian model  
 (G)..... European model  
 (B)..... British model  
 (P)..... General model  
 (R)..... RP model

REMARKS	PARTS NAME
NO MARK	ELECTROLYTIC CAPACITOR
⊗	TANTALUM CAPACITOR
⊙	CERAMIC CAPACITOR
⊚	POLYESTER FILM CAPACITOR
⊖	POLYSTYRENE FILM CAPACITOR
⊕	MICA CAPACITOR
⊚	POLYPROPYLENE FILM CAPACITOR
⊙	SEMICONDUCTIVE CERAMIC CAPACITOR

LAST NO.	UN LISTED NO.
C	625
R	675
Q	510
D	513
IC	508

PIN CONNECTION DIAGRAM OF TRANSISTORS, DIODES AND ICs.	
2SA970(GR, BL) 2SK105(F, H) 2SC2240(GR, BL) 2SC1815(O, Y) 2SC2878(A, B)	2SC1740(R, S) 2SA933S(Q, R) DTA143ES DTA144ES DTA144ES DTA124ES
2SA1145(O, Y) 2SC2705(O, Y)	2SA1349
2SC1308(O, Y) 3288(O, Y)	1SS133 MA185 MTZJ24B MTZJ6 6B MTZJ7 5A MTZJ3 6B MTZJ6 2B
SLR-34VC3H3 SLR-34DC3H4	NJM2068D-D NJM78M15FA NJM79M15FA
PC4570HA NJM4556S-A NJM4556S-F NJM4568S NJM2068S	BA3122N A

• The voltages are measured by no-signal mode.  
 • All voltages are measured with a 10MΩ/V DC electric volt meter.  
 • Components having special characteristics are marked △ and must be replaced with parts having specifications equal to those originally installed.  
 • Schematic diagram is subject to change without notice.